

## Background

Please find below instruction highlighting the importance of pre-compression and lubrication for easier installation using Roxtec installation tools:

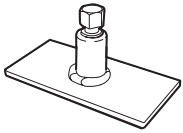

Pre-compression tool S

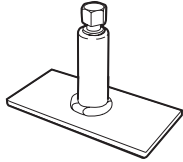

Pre-compression tool L

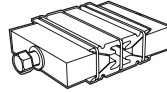

Pre-compression wedge



## Installation instructions Roxtec EMC Compression Pre-compression and lubrication

### Lubrication

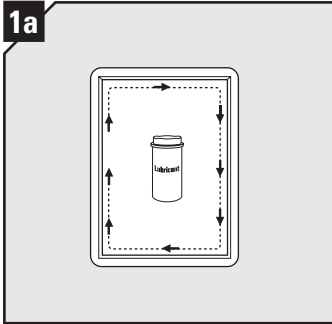

Always start by lubricating the frame.

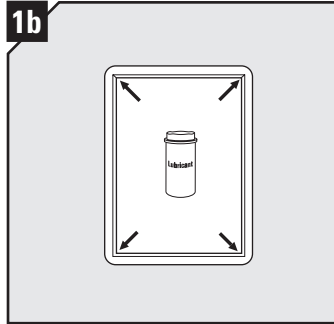

Make sure to lubricate the four corners.

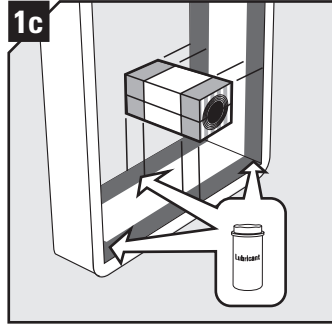

If possible, avoid lubricant on the surface where the conductive tape will be placed.

### Pre-compression

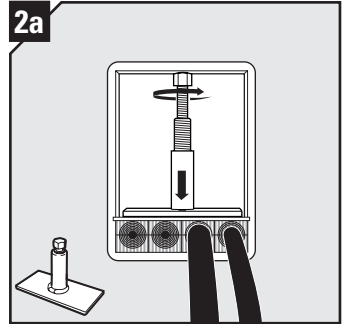

Pre-compress using a pre-compression tool after each row of modules. Expand the bolt and pre-compress until appropriate size of Roxtec modules.

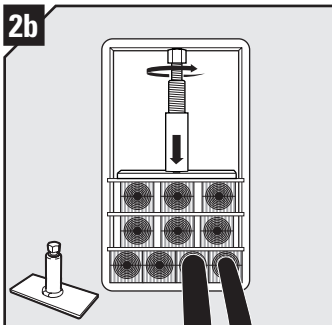

If necessary, use spare modules to build necessary height.

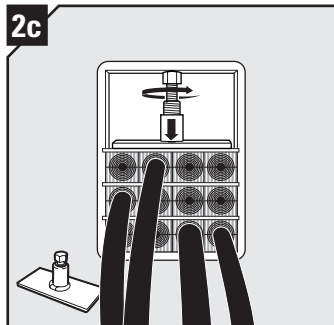

Repeat procedure using either Roxtec pre-compression tool L or Roxtec pre-compression tool S depending on space available.

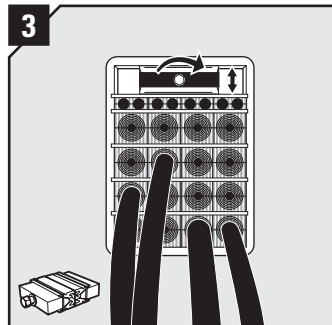

Finalize pre-compression by using Roxtec pre-compression wedge.

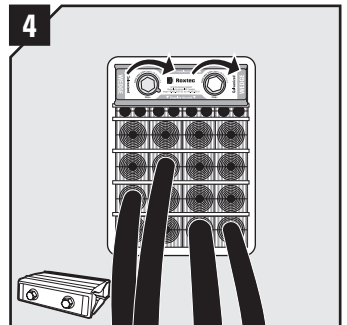

Install the Roxtec Wedge.

### Summary

To secure the performance of an EMC transit the subjects mentioned is recommended. Building too many rows of modules without pre-compressing can cause mechanical damage to the conductive tape when it is compressed.

The risk is reduced if the frame is lubricated at the surfaces not in contact with the conductive tape. The lubricant will reduce the friction and make the installation gas/water tight. Avoid getting lubricant on the conductive tape.

For a complete installation, see installation instruction.

### DISCLAIMER

"The Roxtec cable entry sealing system ("the Roxtec system") is a modular-based system of sealing products consisting of different components. Each and every one of the components is necessary for the best performance of the Roxtec system. The Roxtec system has been certified to resist a number of different hazards. Any such certification, and the ability of the Roxtec system to resist such hazards, is dependent on all components that are installed as a part of the Roxtec system. Thus, the certification is not valid and does not apply unless all components installed as part of the Roxtec system are manufactured by or under license from Roxtec ("authorized manufacturer"). Roxtec gives no performance guarantee with respect to the Roxtec system, unless (I) all components installed as part of the Roxtec system are manufactured by an authorized manufacturer and (II) the purchaser is in compliance with (a), and (b), below. (a) During storage, the Roxtec system or part thereof, shall be kept indoors in its original packaging at room temperature. (b) Installation shall be carried out in accordance with Roxtec installation instructions in effect from time to time. The product information provided by Roxtec does not release the purchaser of the

Roxtec system, or part thereof, from the obligation to independently determine the suitability of the products for the intended process, installation and/or use. Roxtec gives no guarantee for the Roxtec system or any part thereof and assumes no liability for any loss or damage whatsoever, whether direct, indirect, consequential, loss of profit or otherwise, occurred or caused by the Roxtec systems or installations containing components not manufactured by an authorized manufacturer and/or occurred or caused by the use of the Roxtec system in a manner or for an application other than for which the Roxtec system was designed or intended. Roxtec expressly excludes any implied warranties of merchantability and fitness for a particular purpose and all other express or implied representations and warranties provided by statute or common law. User determines suitability of the Roxtec system for intended use and assumes all risk and liability in connection therewith. In no event shall Roxtec be liable for indirect, consequential, punitive, special, exemplary or incidental damages or losses."



Roxtec International AB  
Box 540, 371 23 Karlskrona, SWEDEN  
PHONE +46 455 36 67 00, FAX +46 455 820 12  
EMAIL info@roxtec.com, www.roxtec.com