

# Roxtec ComSeal™ Silicone

A high temperature sealing solution for quick installation

- Available in two standard sizes
- High temp solution for up to 150° C
- Available as Roxtec BG™ B for bonding & grounding
- Supplied in complete kits
- Approved for IP 54
- Two ways attachment
- Frame material in aluminum/acid-proof stainless steel
- EN 45545: HL3 rated material for requirement sets R22 and R23



ComSeal Silicone 16/4 kit



ComSeal Silicone 32/8 kit



ComSeal Silicone AISI 316 32/8 BG B kit

## ComSeal Silicone 16 kit

Name	Number of cables and Ø (mm)		External dimensions WxHxD (mm)	Aperture dimensions WxH (mm)	Weight (kg)	Art.No
ComSeal Silicone 16/4	3 x Ø 27.6	1 x Ø 15	80.5 x 233 x 33	56 x 209	0.611	158373
ComSeal Silicone 16/4	4 x Ø 22.9		80.5 x 233 x 33	56 x 209	0.623	158375
ComSeal Silicone 16/6	6 x Ø 15		80.5 x 233 x 33	56 x 209	0.645	158374

## ComSeal Silicone 32 kit

Name	Number of cables and Ø (mm)			External dimensions WxHxD (mm)	Aperture dimensions WxH (mm)	Weight (kg)	Art.No
ComSeal Silicone 32/7	4 x Ø 21	1 x Ø 21.4	2 x Ø 15	135 x 241 x 33	103 x 209	1.161	158352
ComSeal Silicone 32/7	4 x Ø 21	3 x Ø 15		135 x 241 x 33	103 x 209	1.168	158353
ComSeal Silicone 32/7	4 x Ø 28.3	3 x Ø 15		135 x 241 x 33	103 x 209	1.125	158354
ComSeal Silicone 32/8	8 x Ø 22.9			135 x 241 x 33	103 x 209	1.116	158340
ComSeal Silicone 32/8	8 x Ø 21			135 x 241 x 33	103 x 209	1.135	158343

## ComSeal Silicone AISI 316 32 BG B kit

Name	Number of cables and Ø (mm)		External dimensions WxHxD (mm)	Aperture dimensions WxH (mm)	Weight (kg)	Art.No
ComSeal Silicone AISI316 32/8 BG B	4 x Ø 22.9	4 x Ø 23.4 BG B	135 x 241 x 33	103 x 209	1.186	158949
ComSeal Silicone AISI316 32/6 BG B	4 x Ø 22.9	2 x Ø 23.4 BG B	135 x 241 x 33	103 x 209	1.186	158966

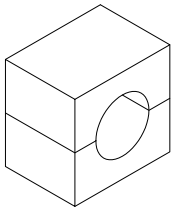

CM Silicone module

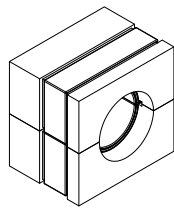

CM BG B Silicone module

## Silicone/Silicone BG B modules

Name	Cable Ø (mm)	External dimensions WxH (mm)	Weight (kg)	Art. No.
CM 20w41/0 Silicone	-	41 x 20	0.031	158301
CM 20w41/15 Silicone	15	41 x 20	0.024	158934
CM 20w41/2x15 Silicone	2 x 15	41 x 20	0.017	158298
CM 40w41/0 Silicone	-	41 x 40	0.062	158302
CM 40w41/15 Silicone	15	41 x 40	0.055	158265
CM 40w41/21 Silicone	21	41 x 40	0.049	158284
CM 40w41/21.4 Silicone	21.4	41 x 40	0.048	158296
CM 40w41/22.9 Silicone	22.9	41 x 40	0.046	158289
CM 40w41/27.6 Silicone	27.6	41 x 40	0.039	158291
CM 40w41/28.3 Silicone	28.3	41 x 40	0.038	158292
CM 39w41/23.4 BG B Silicone	23.4	41 x 39	0.061	158771

Roxtec can supply different water-cut sizes upon request.

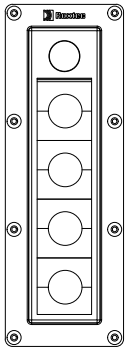

ComSeal Silicone 16/4 kit

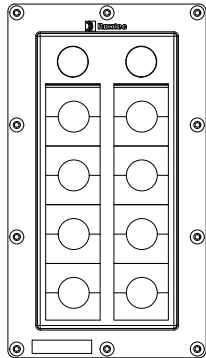

ComSeal Silicone 32/8 kit

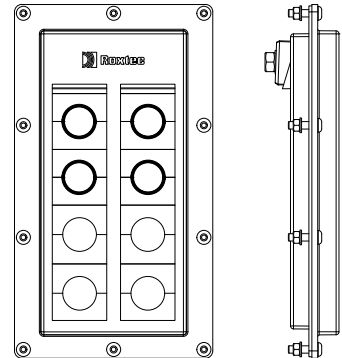

ComSeal Silicone AISI 316 32/8 BG B kit

## Each kit consists of:

- Roxtec ComSeal™ Silicone frame
- Roxtec Silicone/Silicone BG™ B modules
- Screws, nuts and washers
- Roxtec Lubricant
- Silicone gasket/Conduit silicone gasket

If you have questions or wish to order this customized solution, please contact us. You find details about your nearest Roxtec representative on [roxtec.com](http://roxtec.com).