

RAM

Radienmodule Typ RAM ermöglichen den Einsatz von Leitungen in den Radien und optimieren somit den Füllfaktor der Radienrahmen.

- Bestehen aus halogenfreiem Material
- RAM-120 mit ein- oder beidseitigen Radius auf Anfrage mit reduzierten Höhe erhältlich (80 & 90 mm)
- Details zur Montage/ Anwendung aus entsprechenden Zertifikaten entnehmen

With radius modules RAM, frame corners can be used for cables or pipes and thereby optimize the fill factor of the radius frames.

- Made of halogen-free material
- RAM-120 with radius on one or both sides available with reduced height on request (80 & 90 mm)
- Detailed information about installation and use may be found in the corresponding certificates

Beispiele/Examples:
Rahmentyp/ Frame type **SPK-S50**
Kabel/ Cable \varnothing 40 mm

RAM-S50-60/40

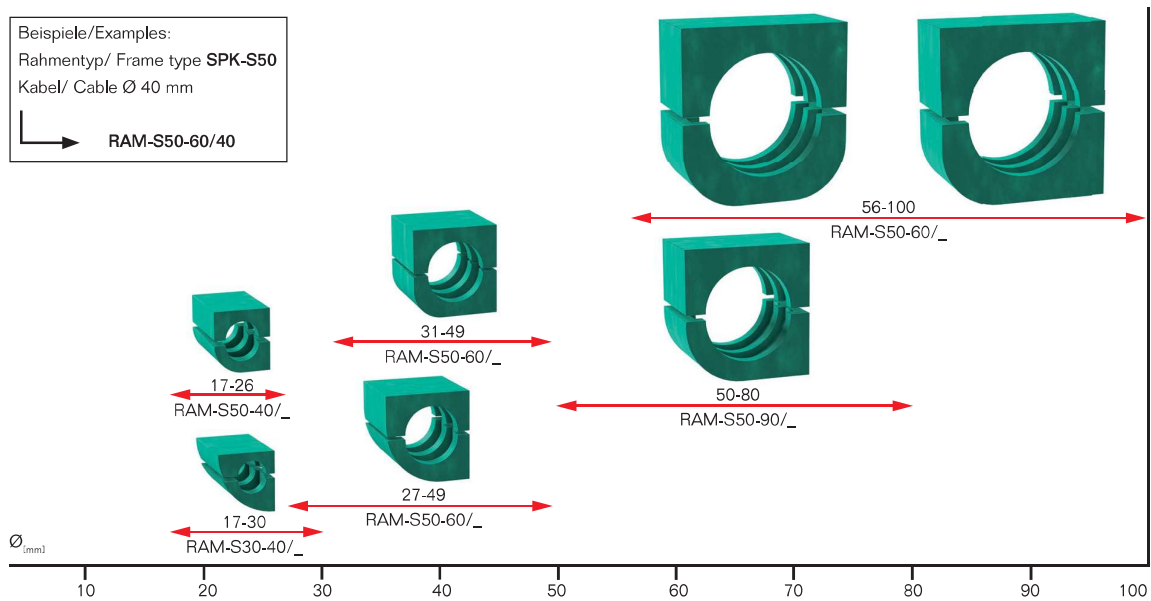

Maße

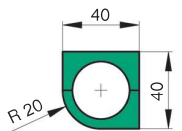

RAM-S30-40/_

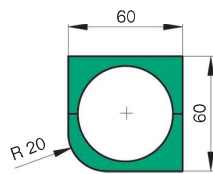

RAM-S30-60/_

Dimensions

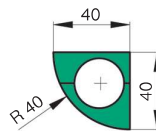

RAM-S50-40/_

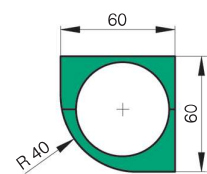

RAM-S50-60/_

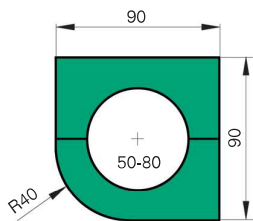

RAM-1xS50 90/_

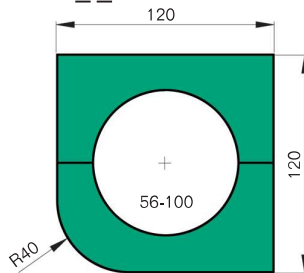

RAM-1xS50 120/_

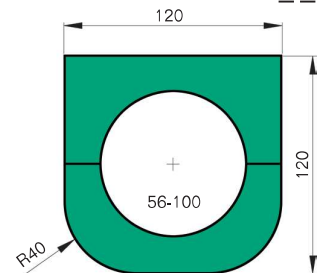

RAM-2xS50 120/_